

JCM INDUSTRIES

P. O. Box 1220, Nash, TX 75569-1220

Phone 800-527-8482 or 903-832-2581

Fax 800-874-9524 or 903-838-6260

www.jcmindustries.com

Typical Specification

Dismantling joints shall be a fabricated unit that allows adjustment of the fitting within a defined tolerance of expansion/contraction for adaption or retrofit of required pipeline appurtenances. Fabrications shall incorporate a slip-pipe design which can be field adjusted to allow for installation of flanged fittings within an existing piping system. The dismantling joint shall include a flanged coupling adapter and flanged ends suitable for the specific installation.

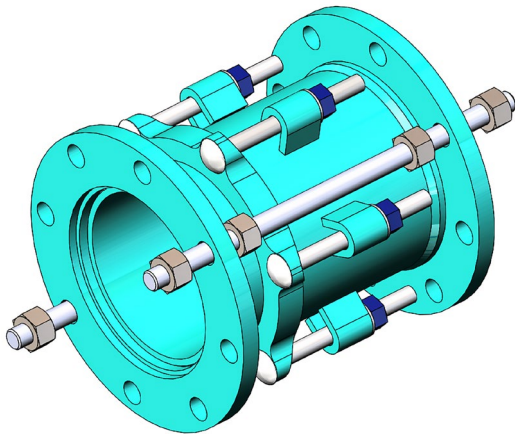

This typical specification, provided by JCM Industries, is a proposed guideline for use by specifying agencies to ensure significant design and material features of this product are included within the agencies' individual specifications.

JCM INDUSTRIES

P. O. Box 1220, Nash, TX 75569-1220

Phone 800-527-8482 or 903-832-2581

Fax 800-874-9524 or 903-838-6260

www.jcmindustries.com

Material Specification

- Flanged Adapter Body:** ASTM A36 or Ductile Iron ASTM A536.
- Follower Flange:** AISI C1012, ASME SA36, or Ductile Iron ASTM A536.
- Flange Extension:** Schedule 40 Steel Pipe
- Bolts:** Corrosion resistant, high strength low alloy ASTM A242, A193 B5, B7. Optional A193 B8 304 stainless steel or 316 stainless steel.
- Finish:** Heavy coat of corrosion resistant metal primer.
Optional Fusion Applied Epoxy Coating per ANSI/AWWA C-213 available.
Other coatings available.
- Gasket:** Nitrile - Specially compounded new rubber polymer for superior shelf life and resistance to permanent set. Recommended for water, salt solutions, mild acids, bases.
- Standard Flange:** ASME/ANSI B16.1 Class 125 Compatible Steel Ring Flange

JCM 300 Series fittings are ANSI/NSF Standard 61, Annex G and ANSI/NSF Standard 372 Certified.
JCM 300 Series fittings meet ANSI/AWWA Standard C219 as applicable.