



JCM Industries, Inc.

**Fittings & Fabrications
for Repair - Connection - Branching
All Types and Sizes of Pipe**

JCM Industries, Inc.
P.O. Box 1220 - Nash, TX 75569-1220
Office: 903-832-2581, Fax: 903-838-6260
www.jcmindustries.com

Call Toll Free: 800-527-8482
Fax Toll Free: 800-874-9524
Email: sales@jcmindustries.com

JCM 105 COLLAR LEAK CLAMPS JCM 135 ALL STAINLESS STEEL COLLAR LEAK CLAMPS

For Quick, Permanent repairs of solvent weld PVC pipe joints.



JCM 105/135 Collar Leak Clamps provide a simple, quick solution to troublesome leaks in threaded joint steel pipe and PVC solvent weld pipe systems - without having to cut out fittings or modifying your system. These heavy duty clamps have many features which assure a successful repair, even under the most adverse conditions. Designed with an additional thickness of gasket in one end of the clamp to accommodate a coupling wall thickness greater than 5/32" and less than 5/16", the JCM 105 Collar Leak Clamp and the 135 All Stainless Steel Collar Leak Clamp provide a convenient, economical repair to leaking solvent weld collar joints and is suitable for threaded coupling joints. For specific dimensional information, contact JCM Engineered and Technical Sales. Custom engineered sizes and configurations available.

JCM 105 Collar Leak Clamps are furnished with a step gasket

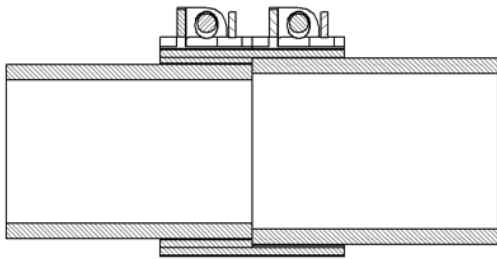

105 Collar Leak Clamps with step gasket to accommodate solvent weld PVC joints.

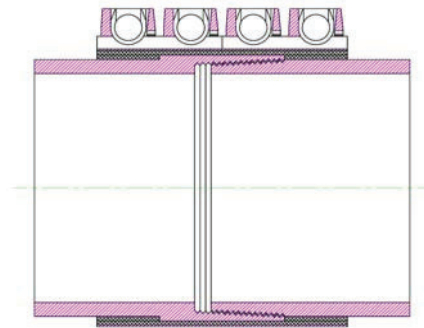

Custom Engineered Clamps with step gasket for threaded coupling.

Meets ANSI/AWWA C230 Stainless-Steel Full-Encirclement Repair and Service Connection Clamps as applicable.
JCM 100 Series Universal Clamp Couplings are ANSI/NSF Standard 61, Annex G and ANSI/NSF 372 Certified.



JCM 105 Collar Leak Clamps

JCM 135 All Stainless Steel Collar Leak Clamps

For Quick, Permanent repairs of solvent weld PVC pipe joints.



JCM 105/135 Collar Leak Clamps provide a simple, quick solution to troublesome leaks in PVC solvent weld pipe systems - without having to cut out fittings or modifying your system. These heavy duty clamps have many features which assure a successful repair, even under the most adverse conditions.

HOW TO ORDER

1. Determine O.D. of pipe.
2. Select proper clamp O.D. range and band width.
3. Specify clamp number. Model 105 for standard clamp
4. For all stainless clamp, change model number to 135.

EXAMPLE:

For 3" Class 160 PVC pipe, order: 105-0350-6.

For All Stainless Clamp, order: 135-0350-6.

NOM PIPE SIZE (IN)	PIPE O.D. SIZE (IN)	TYPE OF SOLVENT WELD PIPE JOINT	Clamp Width	105 CLAMP NUMBER	APPR WT EACH (LBS)	135 ALL STAINLESS CLAMP NUMBER	APPR WT EACH (LBS)
2	2.38	BELL END CLASS 160, 200 SCH 40 COUPLING AND BELL END	6	105-0238-6	7.3	135-0238-6	5.3
			7	105-0238-7	9.3	135-0238-7	6
2-1/2	2.88	BELL END CLASS 160, 200 SCH 40 COUPLING AND BELL END	6	105-0288-6	7.7	135-0288-6	5.7
			7	105-0288-7	9.9	135-0288-7	6
3	3.50	BELL END CLASS 160, 200 SCH 40 COUPLING AND BELL END	6	105-0350-6	8.0	135-0350-6	6
			7	105-0350-7	10	135-0350-7	7
4	4.50	BELL END CLASS 160, 200 SCH 40 COUPLING AND BELL END	6	105-0450-6	9.1	135-0450-6	6
			7	105-0450-7	11	135-0450-7	7
5	5.56	BELL END CLASS 160, 200 SCH 40 COUPLING AND BELL END	6	105-0556-6	9.4	135-0556-6	6.5
			7	105-0556-7	11	135-0556-7	7
6	6.63	BELL END CLASS 160, 200 SCH 40 COUPLING AND BELL END	6	105-0663-6	10	135-0663-6	7.5
			7	105-0663-7	12	135-0663-7	8.5
8	8.63	BELL END CLASS 160, 200 SCH 40 COUPLING AND BELL END	6	105-0863-6	11	135-0863-6	8.7
			7	105-0863-7	13	135-0863-7	9.5

Other widths available upon request

105 COLLAR LEAK CLAMPS FOR PLASTIC IRRIGATION PIPE

NOM PIPE SIZE (IN)	PIPE O.D. SIZE (IN)	CLAMP WIDTH (IN)	FOR PIPE WALL THICKNESS	CLAMP NUMBER	APPR WT EA (LBS)
4	4.125	6	.125	105-0413-6	9.1
6	6.140	6	.150	105-0614-6	9.8
8	8.160	6	.199	105-0816-6	10.7
10	10.200	6	.249	105-1020-6	14.1
12	12.240	6	.290	105-1224-6	14.9
15	15.300	6	.375	105-1530-6	18.0

Other widths available upon request

Collar Leak Clamps are installed with half the clamp over the collar and half on the pipe spigot. The clamp is standard with an additional layer of 1/4" gasket, half the width of the clamp that "steps" down to accommodate the smaller pipe O.D. which butts up against the solvent weld pipe collar at the joint to seal the leak.

